

WLA 25

STGK INC.
ARM + TCL
TOPOTEK1
ATLAS LAB
PFS STUDIO
NIPPAYSAGE
SASAKI ASSOCIATES
MATHEWS NIELSEN
THE PLANNING PARTNERSHIP
RIOS CLEMENTI HALE STUDIOS
R+B LANDSCHAFT S ARCHITEKTUR
KINNEAR LANDSCAPE ARCHITECTS
JAMES CORNER FIELD OPERATIONS
GROUNDLAB WOWHAUS URBANICA





INDUSTRY CITY COURTYARD

MATHEWS NIELSEN



INDUSTRY CITY COURTYARD MATHEWS NIELSEN

Industry City's emerging landscape now includes "Vanishing Point," a 33,000sf courtyard designed to capture the scale and views within the 55' wide by 600' long post-industrial space. Enclosed on three sides by 6-story buildings, the west end of the courtyard is open towards the Gowanus Bay, where you can catch sunset views and a glimpse of the Statue of Liberty.

The building tenants consist of retail, design, and manufacturing companies; with many local start-ups and small businesses. Overall, there are ten buildings in the immediate complex with four seemingly identical courtyards. The buildings and courtyards are now linked by "Innovation Alley," a central pedestrian spine. The courtyard is a destination that offers respite for workers, customers, and the public. The design concept forces the perspective towards "Innovation Alley," so that when visitors arrive at the courtyard from the entrance along 2nd Avenue, the planter walls pull your eye towards the raised intersection at the center of "Innovation Alley" and the courtyard. The same play occurs from the east end of the courtyard where the planting design and trees pull toward this center, in a mirrored perspective.

The project budget called for the use of inexpensive materials intended for a 5-7 year lifespan. The schedule of the project from concept to construction was condensed into just 10 months. The materials were also

chosen based on the post-industrial context. The softness of the ferns and fine texture of the planting palette were chosen to contrast the post-industrial context. To compliment the large mass and immensity of the overall space, the plantings are laid out in large directional swaths and the palette consists of monotone greens. The form of the columnar maple trees was selected to play off of the repetition of the building columns as well as the industrial smoke stacks and ventilation pipe remnants. The tree species was chosen for the beautiful red fall color that will inevitably complement the weathering steel forms in the courtyard.

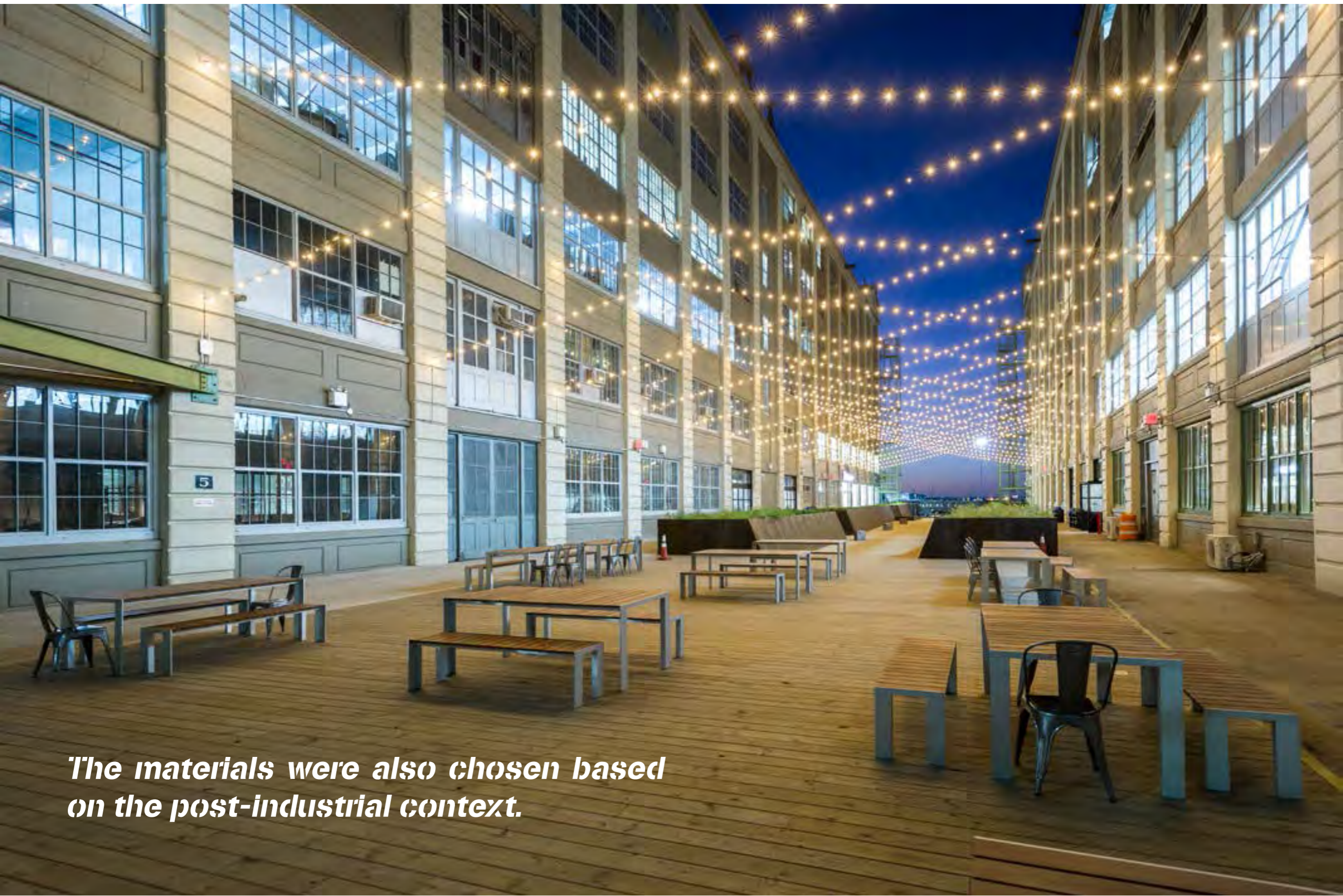

The materials were also chosen based on the post-industrial context.

INDUSTRY CITY COURTYARD MATHEWS NIELSEN

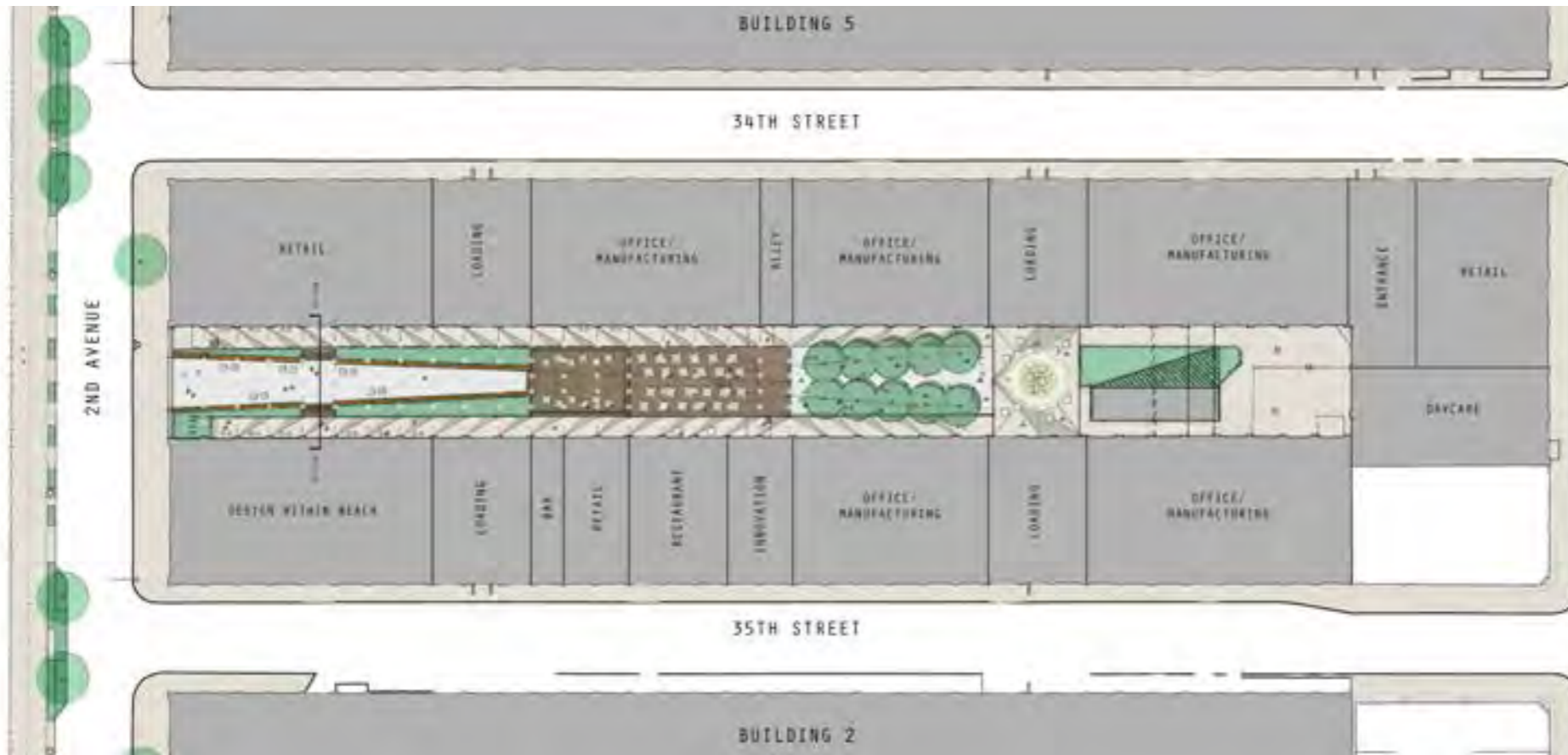

INDUSTRY CITY COURTYARD BROOKLYN, NEW YORK, USA

Design Firm | Mathews Nielsen
Photography | Michael Hnatov; Elizabeth Felicella
Plan Image Credits | Mathews Nielsen